

11. Adjustment

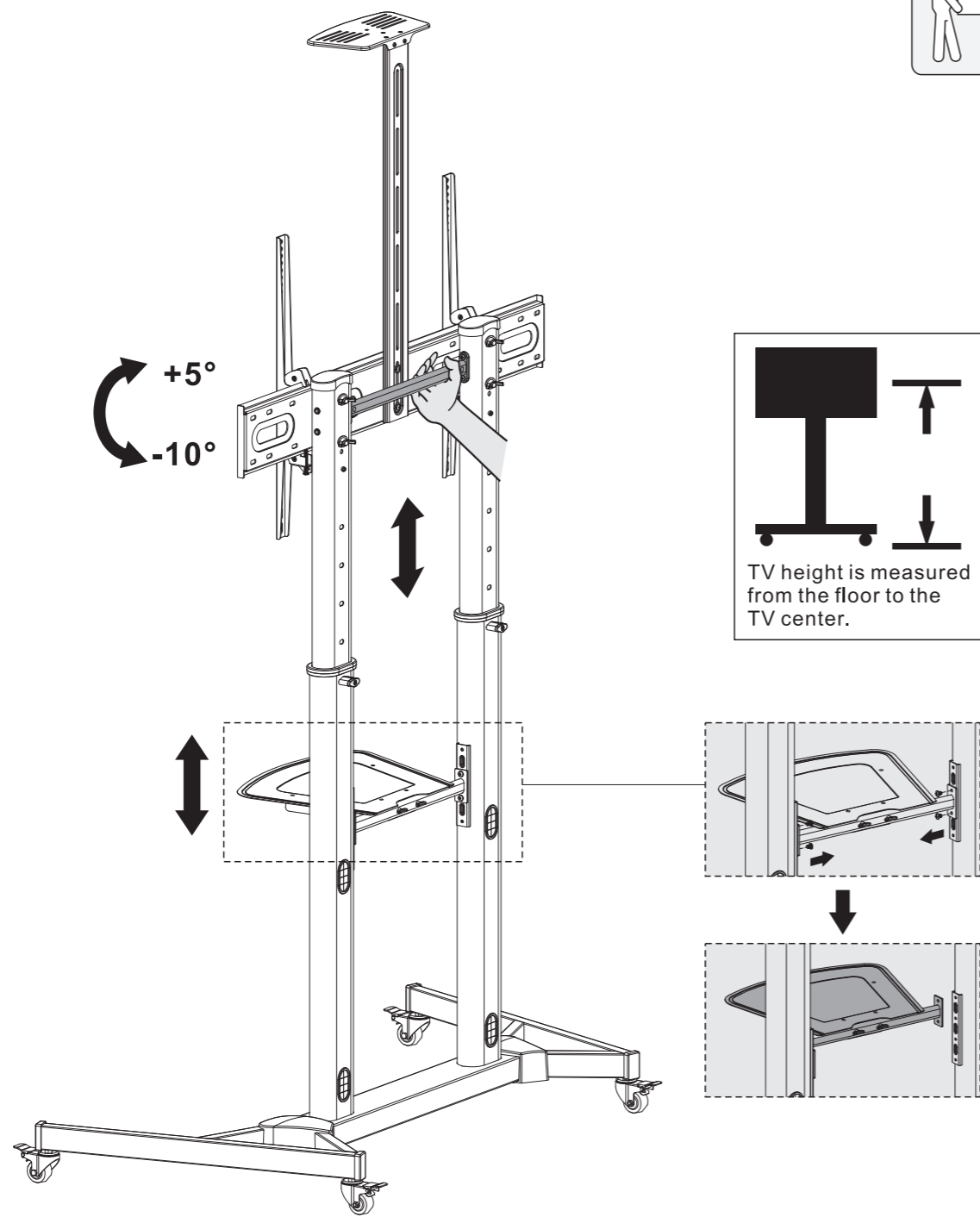

- It is recommended to adjust the columns to the desired height before installing the display.
- If you want to adjust the columns height after finishing the display installation. Please remove the DVD shelf , then adjust the columns to the desired height.

Maintenance

- Check that the bracket is secure and safe to use at regular intervals(at least every three months).
- Please contact your distributor if you have any questions.



TV Cart



WARNING: EXCEEDING THE WEIGHT CAPACITY CAN RESULT IN SERIOUS PERSONAL INJURY OR DAMAGE TO EQUIPMENT!

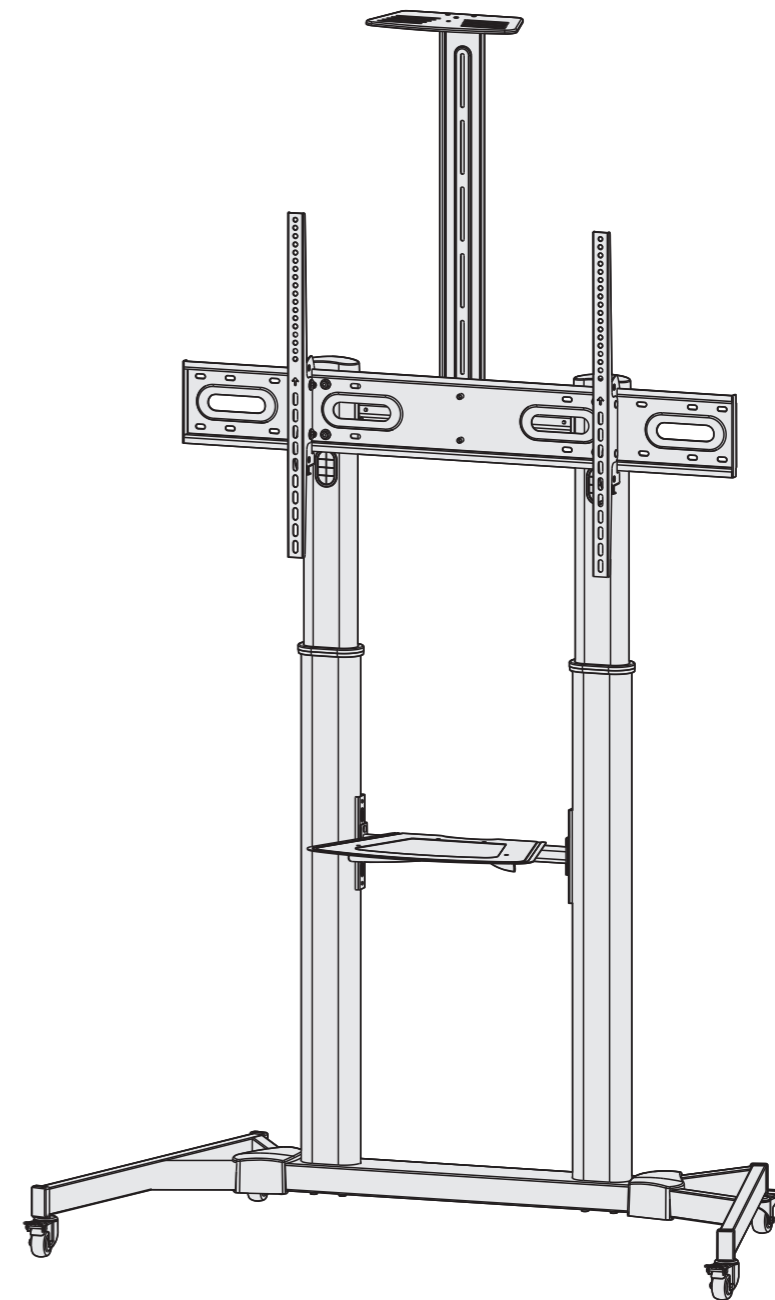

ENGLISH

INSTALLATION MANUAL

FS-3610



200x200/300x300
400x200/400x400
600x400/800x400
800x600/1000x600



100kg/220lbs



5kg/11lbs



5kg/11lbs

NOTE: Read the entire instruction manual before you start assembly.

WARNING

- Do not begin the installation until you have read and understood the instructions and warnings contained in this installation sheet. If you have any questions regarding any of the instructions or warnings, please contact your point of purchase.
- This mounting bracket was designed to be installed and utilized **ONLY** by following the instruction of this manual. Improper installation of this product may cause damage or serious injury.
- This product should only be installed by someone with professional mechanical ability who has basic building experience and fully understands this manual.
- Make sure that the supporting surface will safely support the combined weight of the equipment and all attached hardware and components.
- Always use an assistant or mechanical lifting equipment to safely lift and position the equipment.
- Tighten screws firmly, but do not over tighten. Over tightening can cause damage to the product ,which largely reduces weight capacity.
- This product is for indoor use only. Using this product outdoors could lead to product failure and personal injury.

Requirement for Installation



Parts Checklist

IMPORTANT: Ensure that you have received all parts according to the component checklist prior to installation. If any parts miss or isn't correctly provided, contact your point of purchase for a replacement.



left plastic cover (x1)
A



right plastic cover (x1)
B



base (x1)
C



universal plate (x1)
D



top covers (x2)
E



cable covers (x2)
F

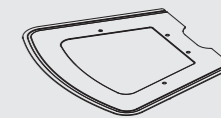

DVD shelf (x1)
G



left column (x1)
H



left adapter bracket (x1)
I

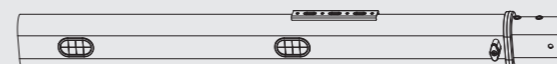

right column (x1)
J

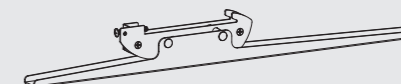

right adapter bracket (x1)
K



camera shelf (x1)
L



connecting plate (x1)
M



crossbar (x1)
N



support bar (x1)
O

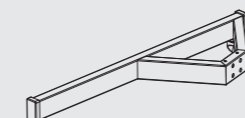

left leg (x1)
P

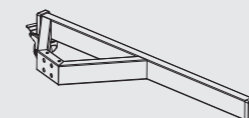

right leg (x1)
Q



butterfly nuts (x2)
R



butterfly nuts (x4)
S

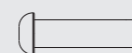

M8x30 (x8)
T

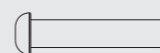

M8x40 (x8)
U



M6x14 (x2)
V



M6x25 (x4)
W



M6x14 (x6)
X



M6x8 (x4)
Y

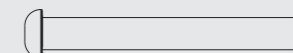

M8x65 (x4)
Z



M4x6 (x3)
A1



M4x6 (x2)
B1



D8 washers (x4)
C1



D6 washers (x2)
D1

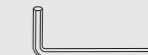

5mm Allen key (x1)
E1



wrench (x1)
F1

Package M



M5x14 (x4)
M-A



M6x14 (x4)
M-B

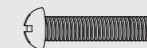

M6x30 (x4)
M-C

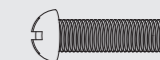

M8x30 (x4)
M-D

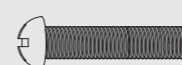

M8x50 (x4)
M-E



washers (x4)
M-F



small spacers (x8)
M-G



big spacers (x8)
M-H

1. Assembling the Base

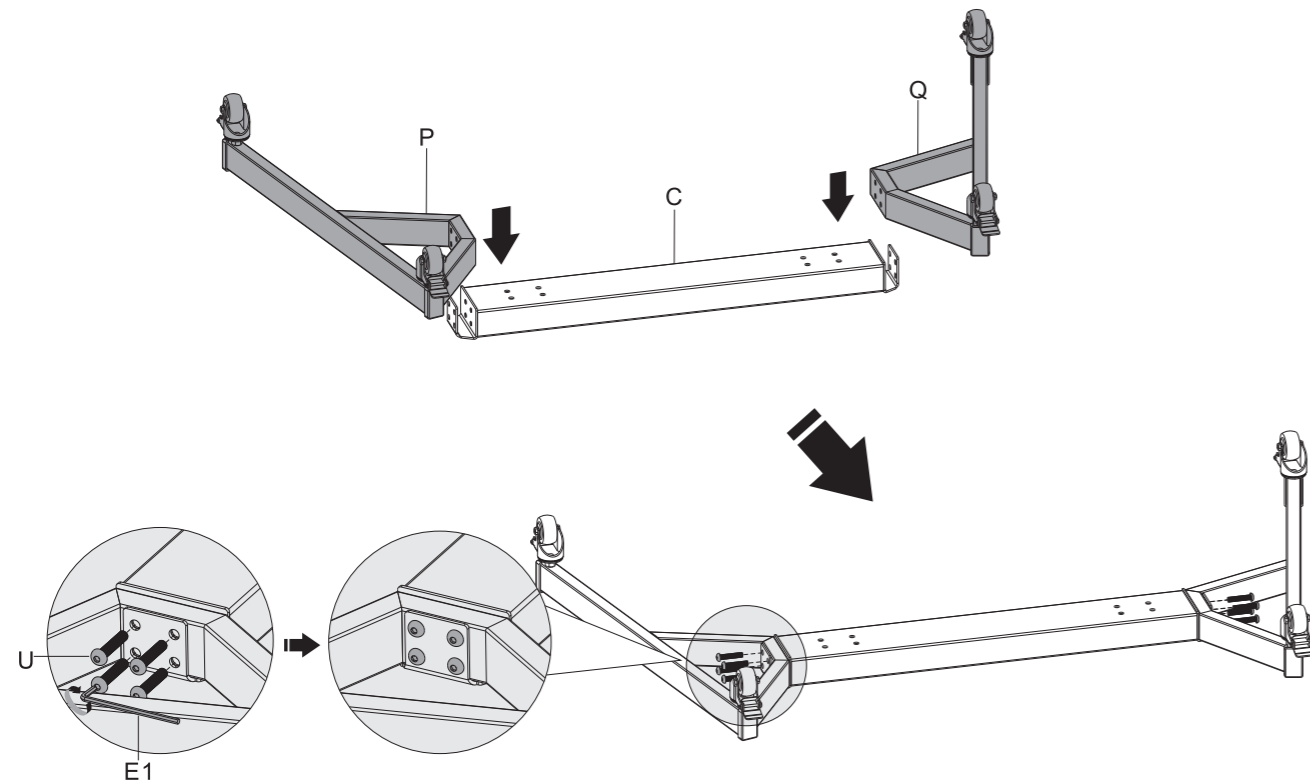

Insert the right base into the base. Align the holes on the right base to the holes on the base .Fix the base with the connecting plate and the screws. Repeat this step for the left base.

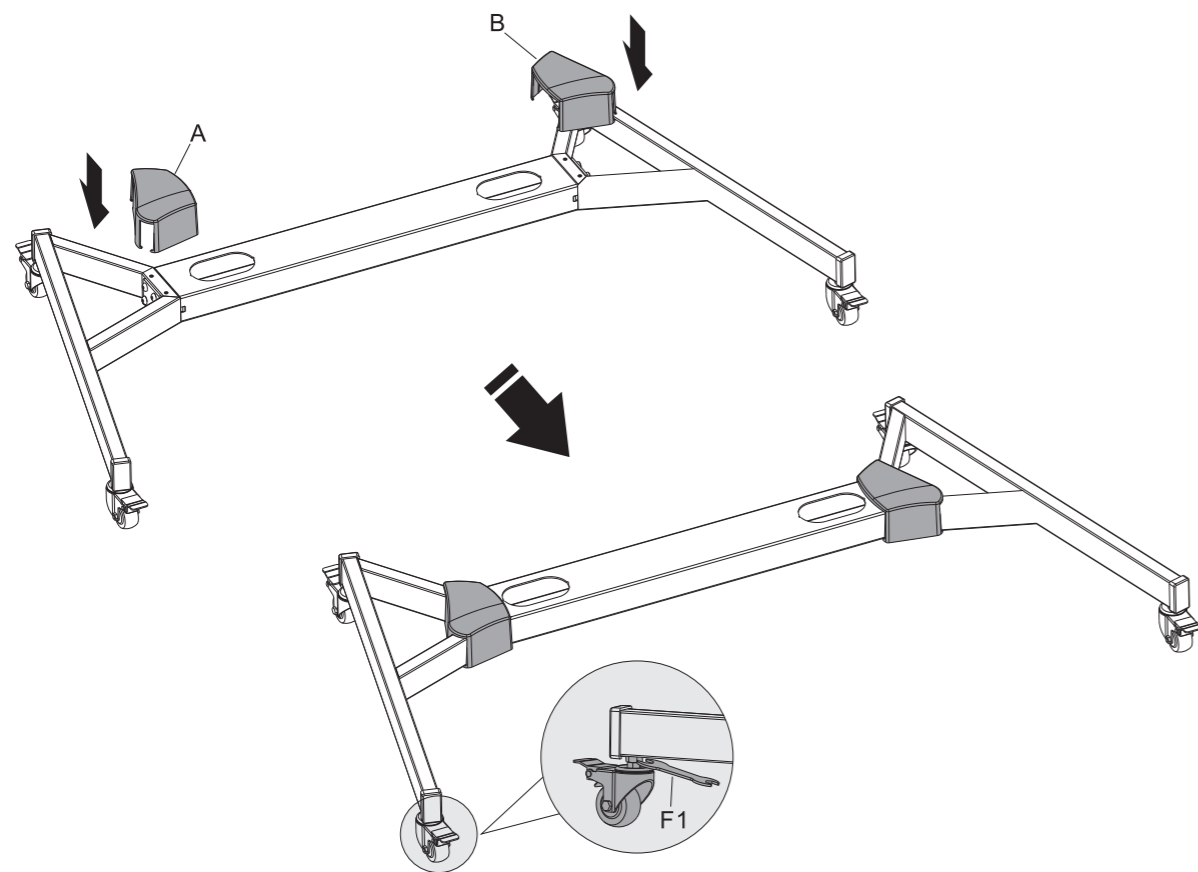

NOTE: Lock the brakes on the casters to avoid any unexpected movements during installation. Each caster can be adjusted independently for fine tuning. Slightly turn the nut to lower or raise the base.

2. Attaching the Columns to the Base

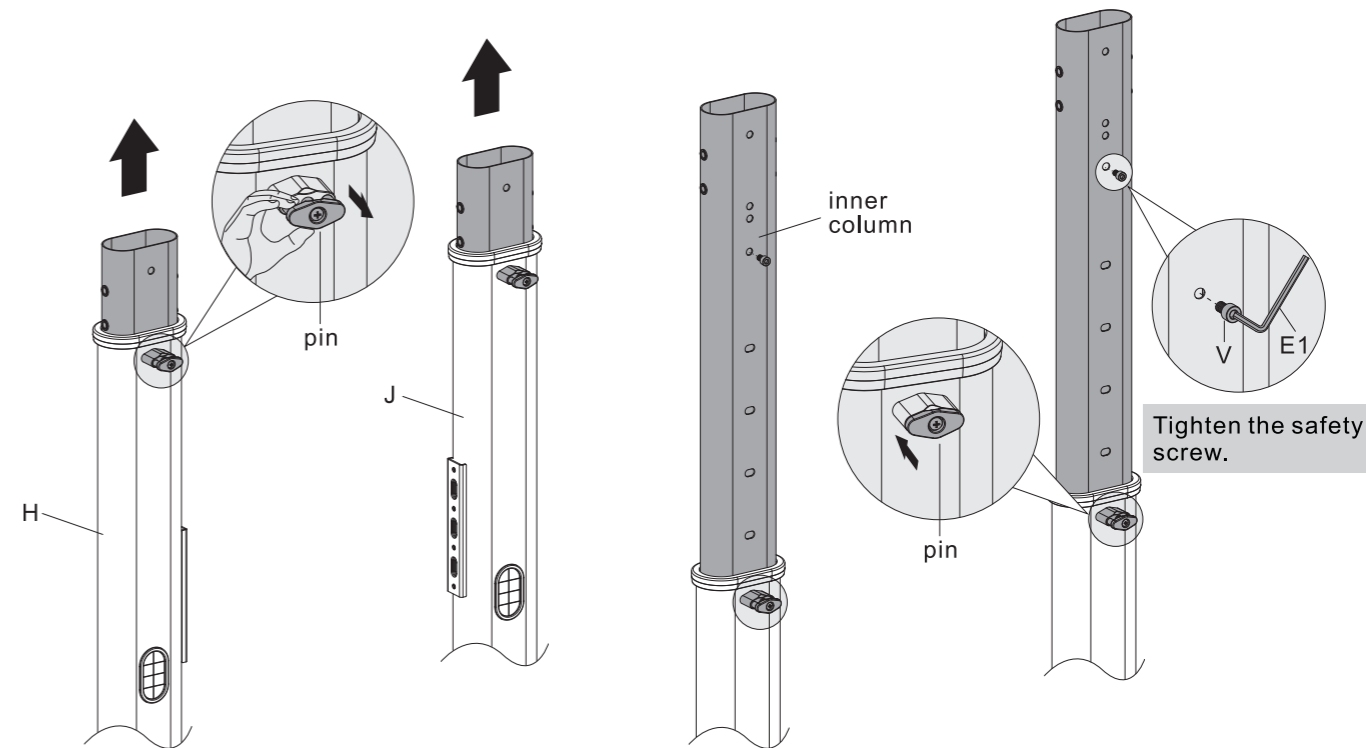

Pull the pin outwards and pull the inner column upwards at the same time, until the inner column is pulled to the desired height then release the pin to secure.

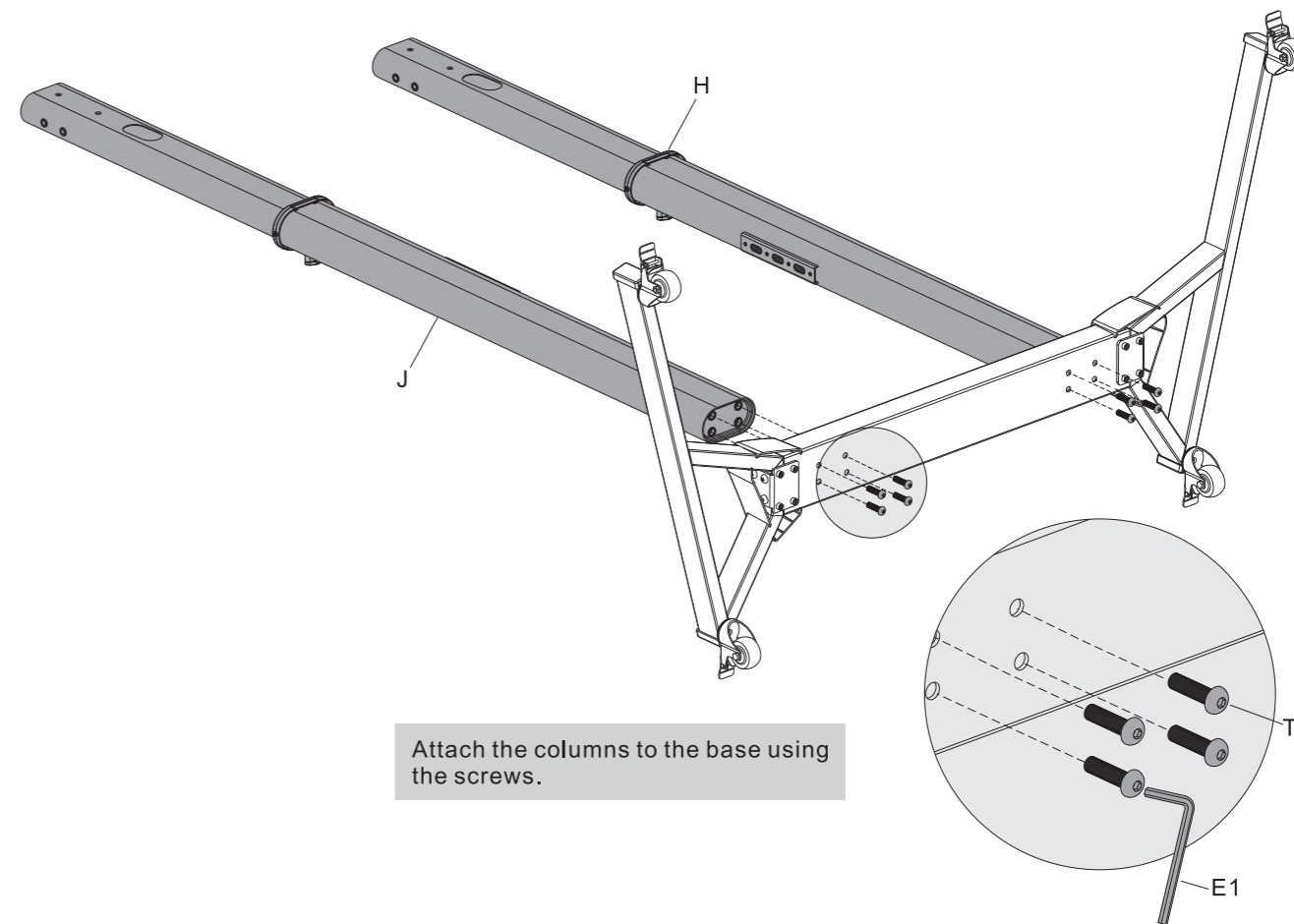

Attach the columns to the base using the screws.

3. Installing the Crossbar

Attach the crossbar to the columns with the appropriate screws. Tighten all screws using a proper Phillips screwdriver.

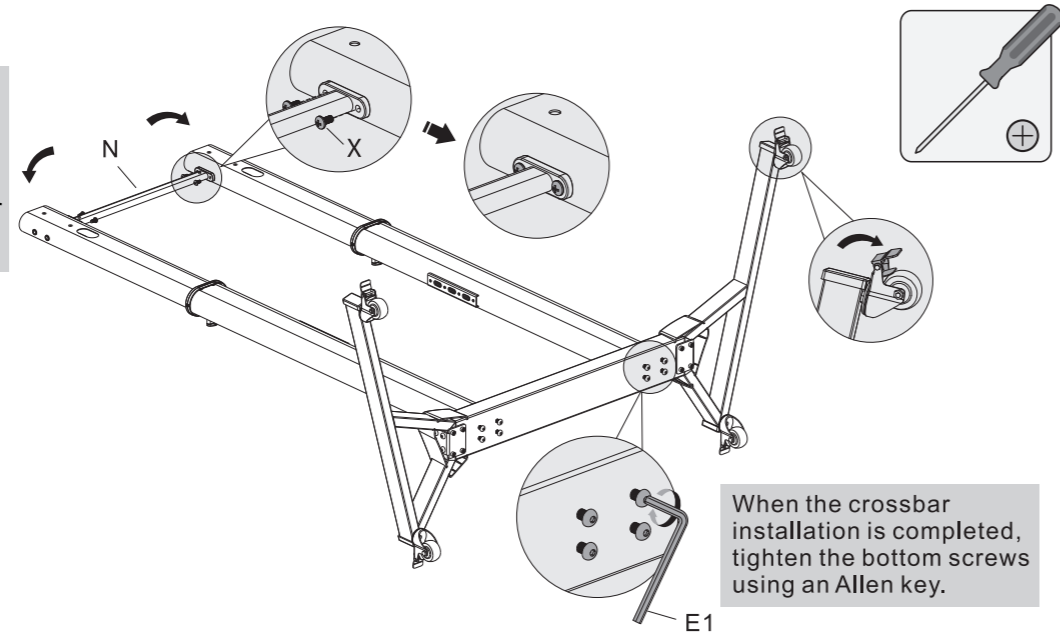

4. Installing the Cable Covers

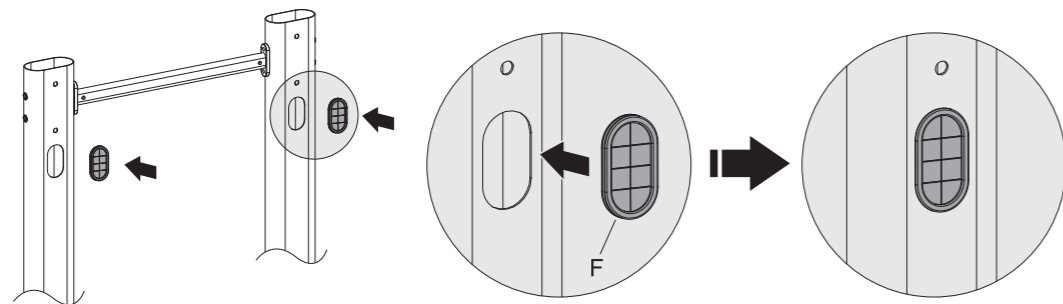

5. Installing the Universal Plate

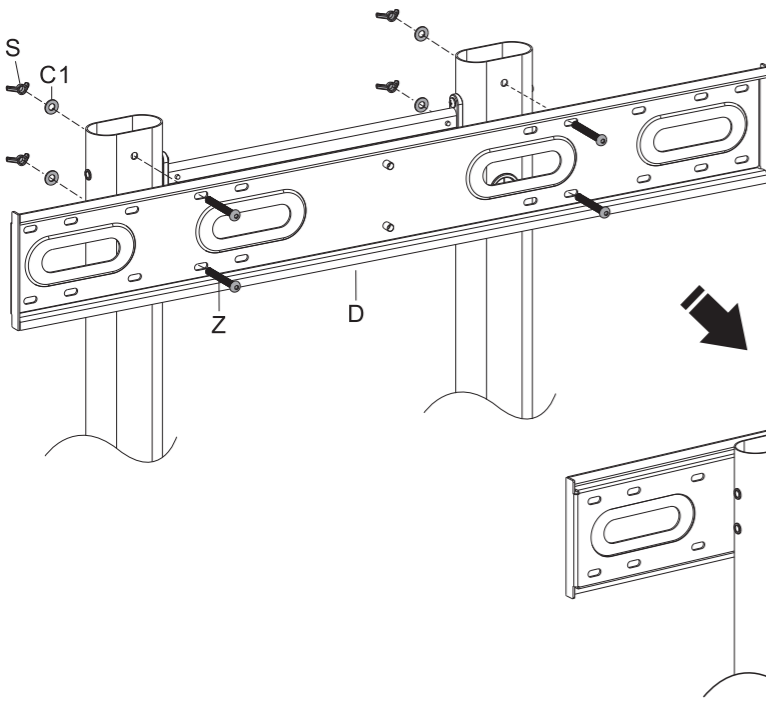

Attach the universal plate to the columns with the appropriate screws, washers and butterfly nuts. Tighten all screws and butterfly nuts.

6. Installing the Adapter Brackets

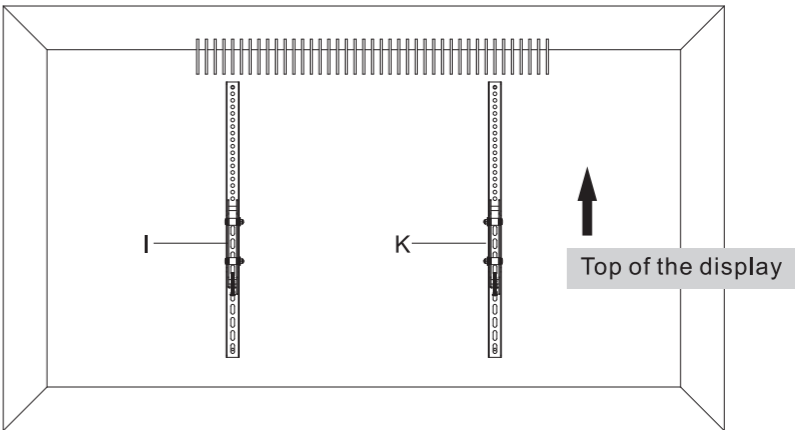

6a. For Flat Back Screens

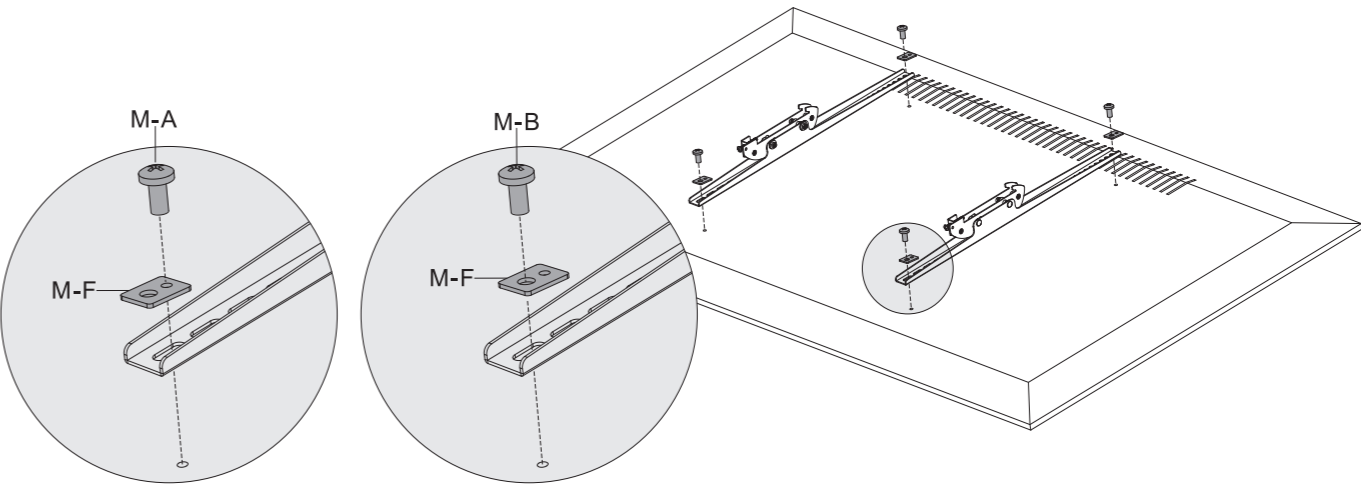
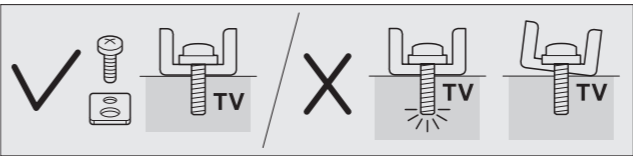

M-A		M-B	

1:1

6b. For Screens with Irregular Back

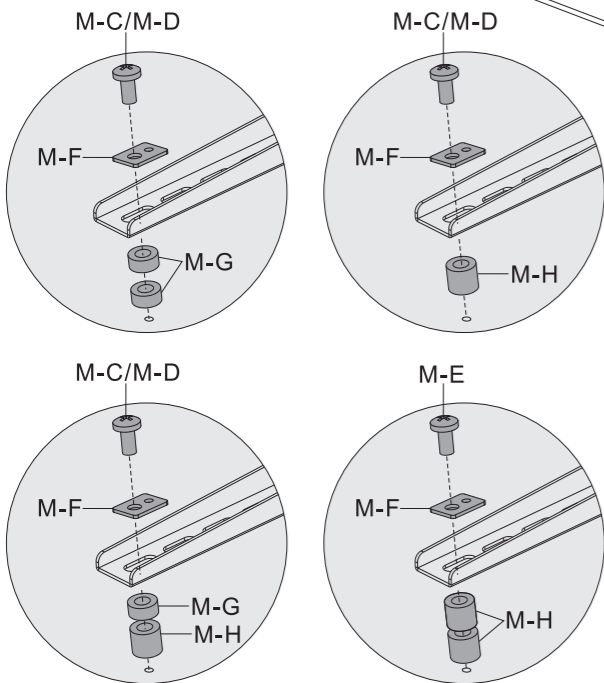
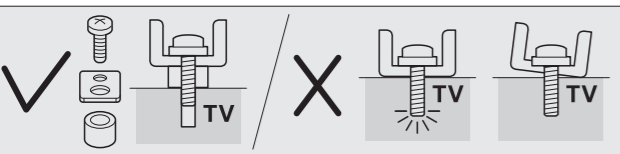

M-C		M-D	
M-E		M-F	
M-G		M-H	

1:1

Note: Choose the appropriate screws, washers and spacers (if necessary) according to the type of screen.

- Position the adapter brackets as close as possible to the center of the display.
- Screw the adapter brackets onto the display.

⚠ Tighten all screws but do not over tighten.

7. Hooking the Display onto the Universal Plate

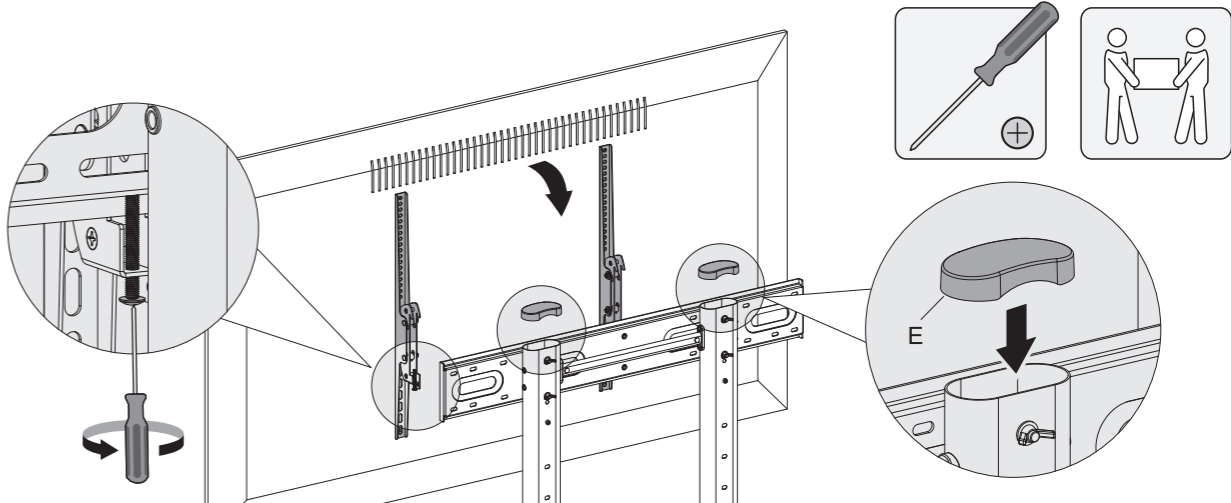

- Hook the display onto the universal plate.
- Tighten the bottom screws to secure them.

IMPORTANT: Make sure the display is mounted correctly and the screws are tightened safely before releasing the display.

8. Installing the Camera Shelf

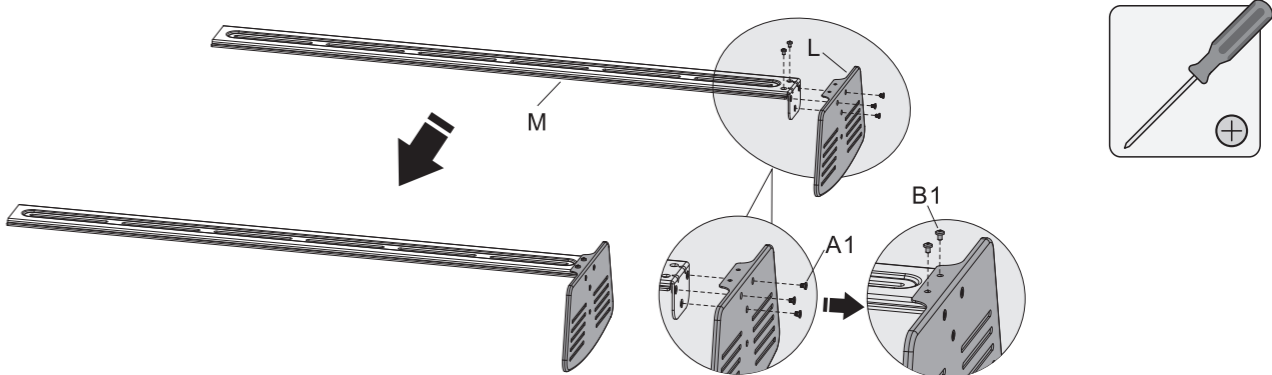

Attach the camera shelf to the connecting plate with the appropriate screws. Tighten all screws using a proper Phillips screwdriver.

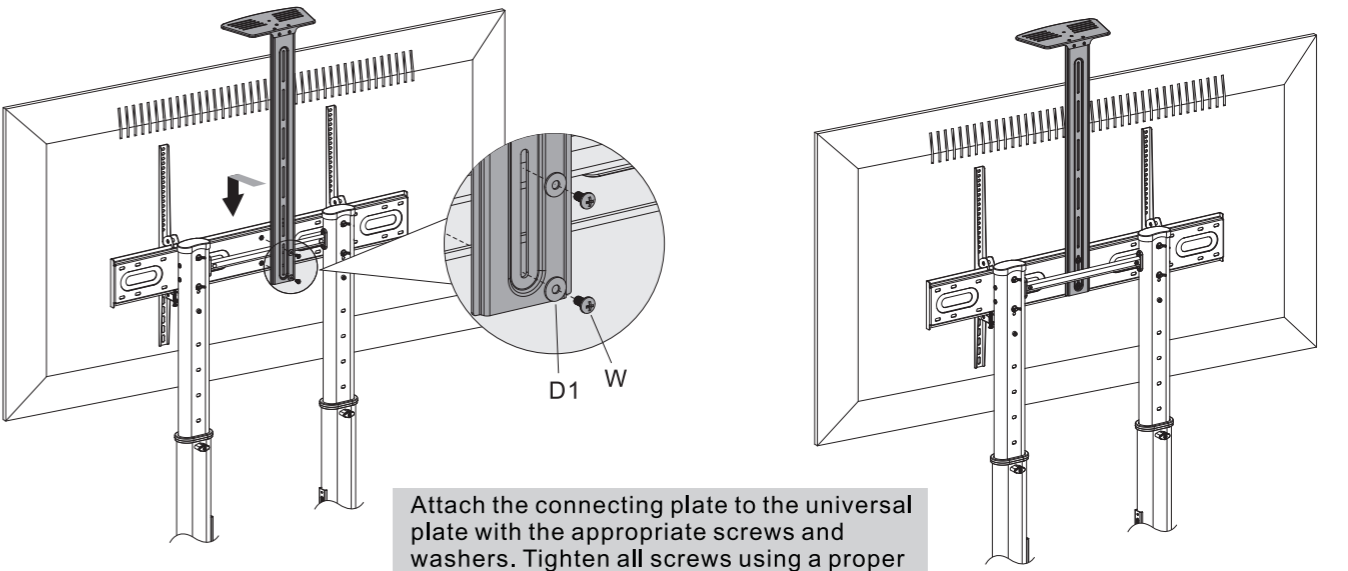

Attach the connecting plate to the universal plate with the appropriate screws and washers. Tighten all screws using a proper Phillips screwdriver.

9. Installing the DVD Shelf

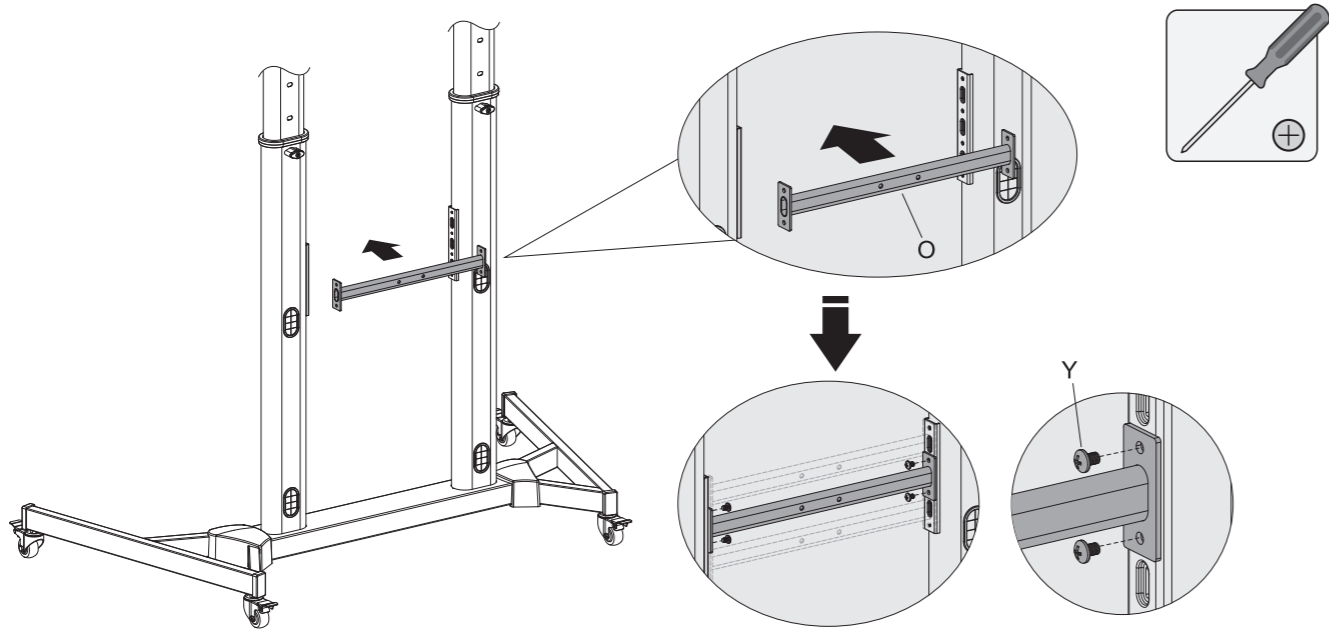

Install the support bar to the columns at the desired position and secure using the appropriate screws.

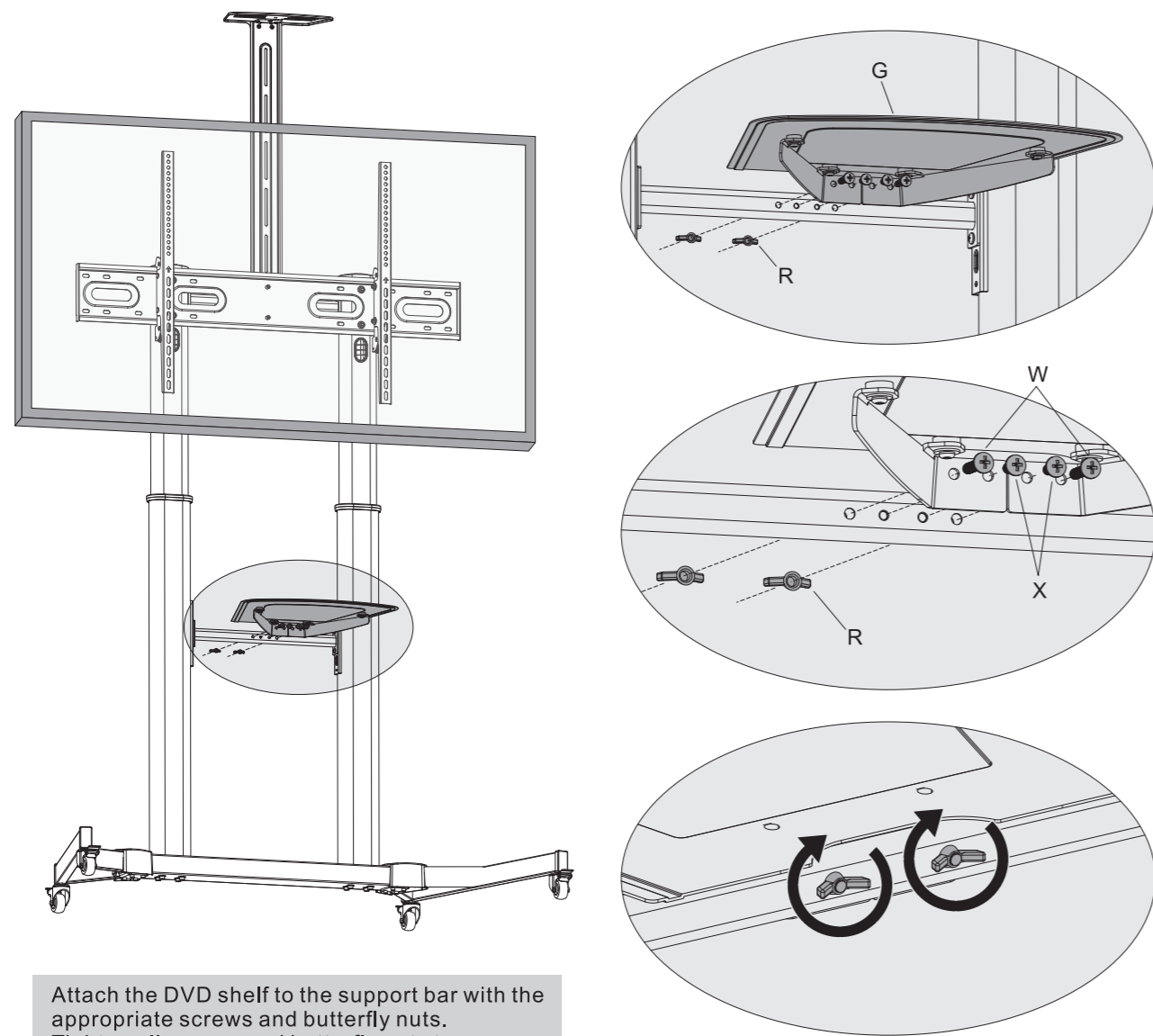

Attach the DVD shelf to the support bar with the appropriate screws and butterfly nuts. Tighten all screws and butterfly nuts to secure.

10. Cable Management

